

Development Management Committee

17th August 2022

Development Management Committee

22/00029/FULPP

**Aldershot Bus Station, 3 Station
Road, Aldershot**

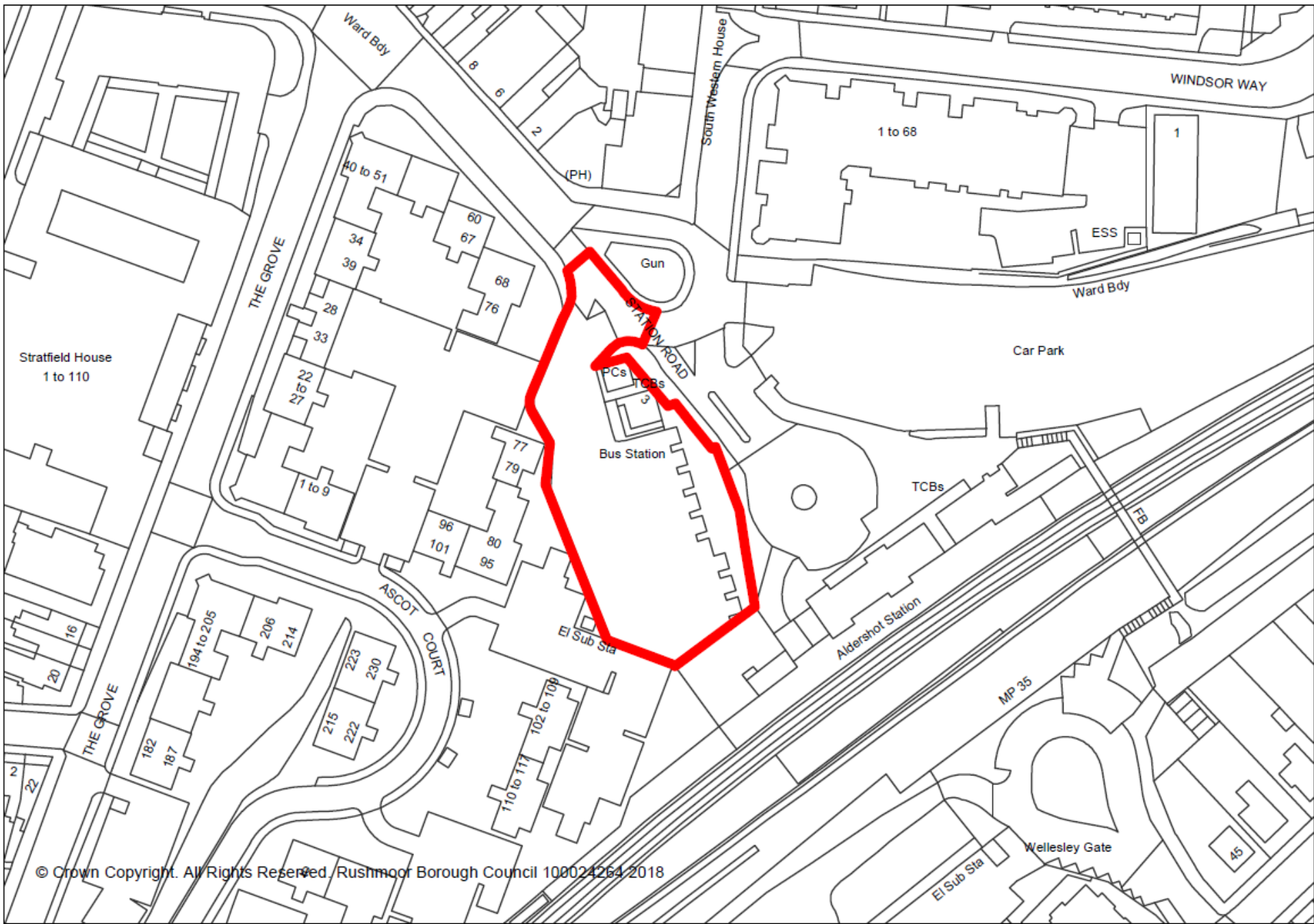



© Crown Copyright. All Rights Reserved. Rushmoor Borough Council 100024264 2018































- Public realm improvements
- Car park development
- Proposed development
- Potential refurbished existing buildings
- Listed buildings

Adopted Aldershot Town Prospectus (January 2016)

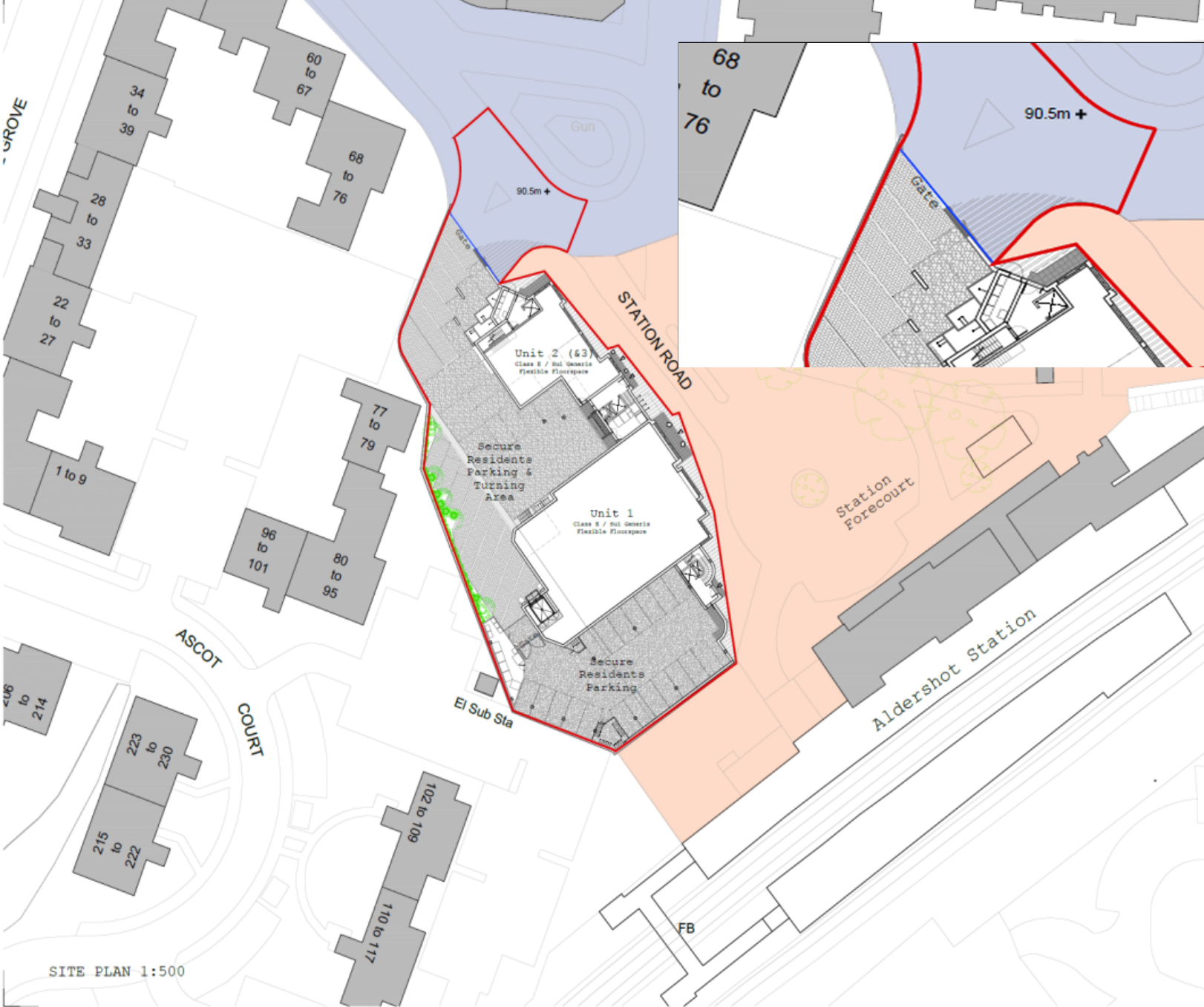

Material Key - Indicative:

	Brick Paviour 1 Vehicle Movement & Car Parking
	Brick Paviour 2 Vehicle Movement & Car Parking
	Entrance Delineations
	Drainage / Fastic Delineations
	Materials to tie in with the Station Forecourt Upgrade (see 07 plan)
	Tarmac
	Solar Farm
	Car Parking Spaces
	Proposed Planting
	Grass
	Green Grow Wall
	Proposed Trees

NOTES:

The Station Forecourt Upgrade is a key part of the Aldershot Bus Station project. All measures to be undertaken will be in accordance with the requirements of the relevant legislation and standards, and the Station will be enhanced.

PLANNING

Author: Mr Simon Gill

Project: Aldershot Bus Station

Drawn By: Site Plan (Ground Floor) As Proposed

Scale: 1:500 Date: NOV 21 Drawn By: GH

Issue: 128-02-10

Revision: 128-02-10

0 5 10 15 20 25

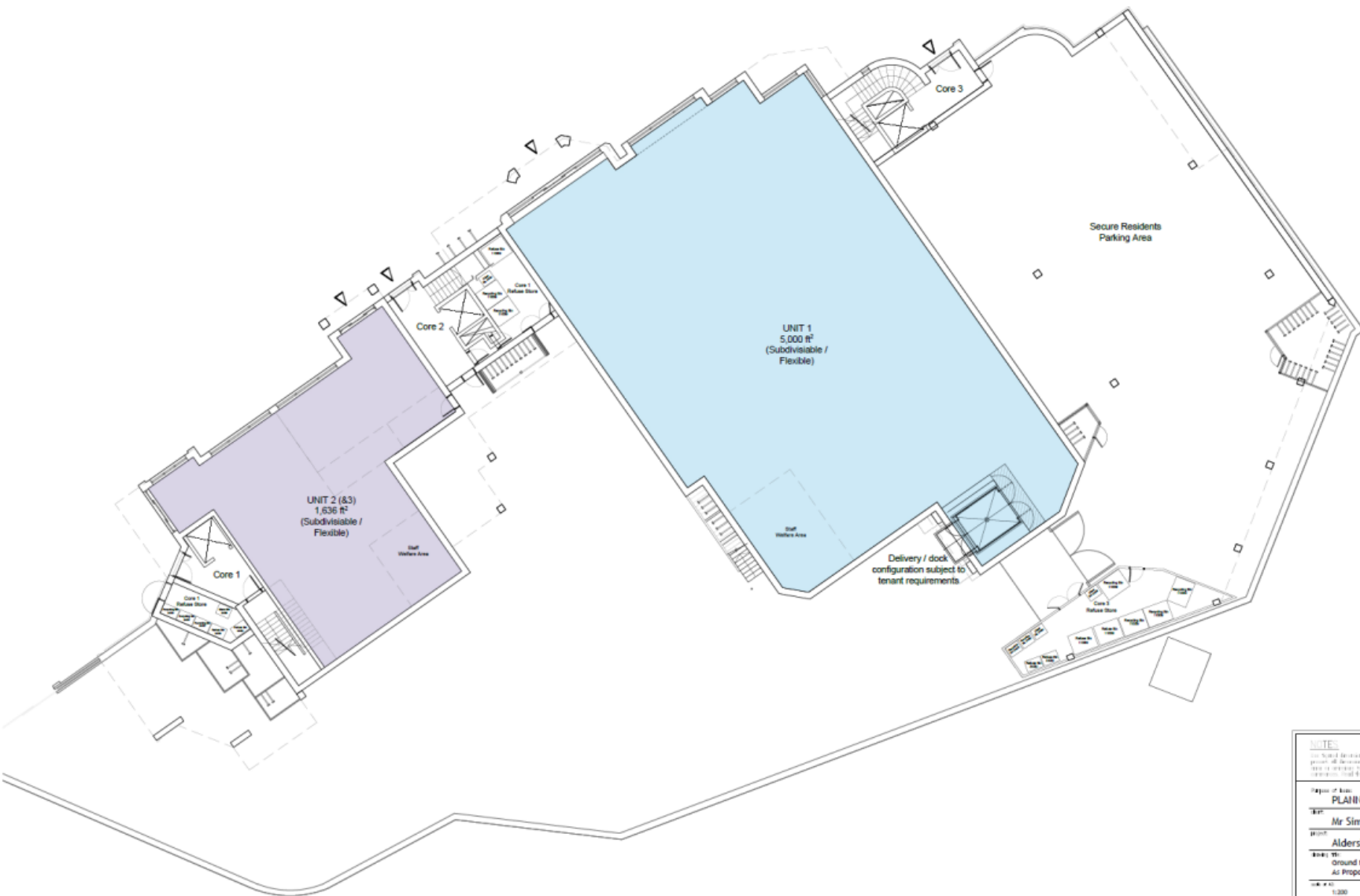

FLOOR PLAN 1:200

NOTES

For Special Meetings, list date, time, place and subject in this space. For all other meetings, list date, time and place in this space. For all other meetings, list date, time and place in this space.

Project or Issue

PLANNING

Mr Simon Gill

project

Aldershot Bus Station

Meeting No

Ground floor Plan As Proposed

Book no	Date	Time	Book by	Booked by
1:2000	NOV 21	100		OK

128-03-10

Location

for 128-03-10

FLOOR PLAN 1:200



NOTES

Use Special Instructions only. Note: drawing only what is with but is present. All drawings to be checked by user with any discrepancies, must be reviewed to be reported to the architect before work commences. Send the drawing with all relevant records.

Phases of Business Planning

Mr Simon C

project: **Aldershot Bus Station**

Second Floor Plan
As Proposed

1:200

128-03-12

Row Date	On Child	Description
----------	----------	-------------

W	Bedroom Wardrobe
Cpd	Storage Cupboard
HN	Home working location (all IT Provisionals)
H/L Windows	High Level Windows above 1.6m
DP	Disabled Refuse Point





FLOOR PLAN 1:200

W	Bedroom Wardrobe
Cpd	Storage Cupboard
HL	Room working location (all 12 footings)
HL	High Level Windows above 1.5m
Windows	Windows
○	Blackball Refuse Point

NOTE:
The Council does not take any responsibility for the accuracy of the information provided in this plan. It is the responsibility of the user to ensure that the information is correct and to ensure that it is used for the intended purpose.

Region of Use:
PLANNING

Site:
Mr Simon Gill

Project:
Aidershot Bus Station

Drawn by:
Third Floor Plan

As Proposed

Scale: 1:200
Date: NOV 21
Drawn by: GSK
Check by: GSK

Study Date:
128-03-13

Version: 1.0

0 2 4 6 8 10m

FLOOR PLAN 1:200



W	Bedroom Wardrobe
Cpd	Storage Cupboard
HW	Home working location (all IT Provisions)
HL	High Level Windows above 1.6m
Windows	Disabled Refuse Point

NOTES

Use Spinal Instruments only. Spinal drawing only when a condition is present. All drawings to be checked by user and any discrepancies, errors or omissions to be reported to the publisher before each submission. Send this drawing with all relevant materials.

Purpose of lesson

Mr Simon Gill

Aldershot Bus Station

Fourth Floor Plan
As Proposed

code: 42	date:	done by:	checked by:
1:200	NOV '21	tp	GM

128-03-14

Rev Date	Rev Chg'd	Description
----------	-----------	-------------





Material Key - Indicative:

	Existing brickwork wall to perimeter
	Proposed brickwork wall
	Proposed stone-like wall masonry
	Proposed render
	Proposed pressed metal roofing system
	Proposed pressed metal walling system - Class A
	Metal mesh to cycle store
	Metal screening to stair
	Glazing - Balustrades
	Glazing - Windows

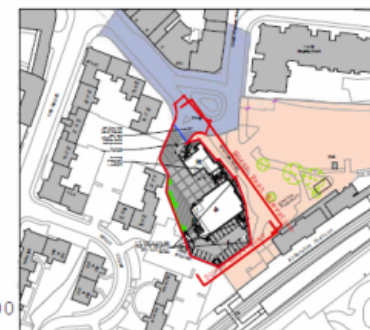

N
O
R
T
H

NOTES

Use stated dimensions only. Check drawing only when a scale bar is present. All dimensions to be checked by user and any discrepancies, errors or omissions to be reported to the architect before work commences. Read this drawing with all relevant materials.

Project of Issue: **PLANNING**

Date: **Mr Simon Gill**

Project: **Aldershot Bus Station**

Drawing title: **Elevations As Proposed**

Scale of 1:200 Date: **NOV '21** Drawn by: **CGH** Checked by: **CGH**

Drawing number: **128-05-20**

Revised: **On '2021** Description:

0 2 4 6 8 10m

PROPOSED ELEVATIONS 1:200

KEY
PLAN
1:2500



- Material Key - Indicative:**
- Existing brickwork wall to perimeter
 - Proposed brickwork wall
 - Proposed stone-like wall masonry
 - Proposed render
 - Proposed pressed metal roofing system
 - Proposed pressed metal walling system - Class A
 - Metal mesh to cycle store
 - Metal screening to stair
 - Glazing - Balustrades
 - Glazing - Windows

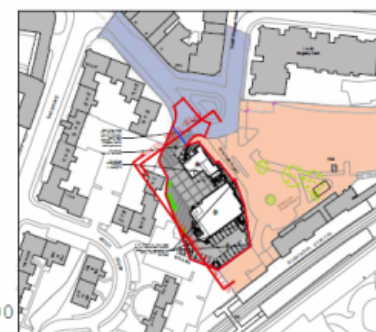

N
O
R
T
H

NOTES

Use figures dimensions only. Scale drawing only when a scale bar is present. All dimensions to be checked by user and any discrepancies, error or omissions to be reported to the architect before any construction. Read the drawing with all relevant information.

Project of Issue: **PLANNING**

Client: **Mr Simon Gill**

Project: **Aldershot Bus Station**

Drawing title: **Elevations**

Scale of this: **1:200** Date: **NOV 21** Drawn by: **SP** Checked by: **CM**









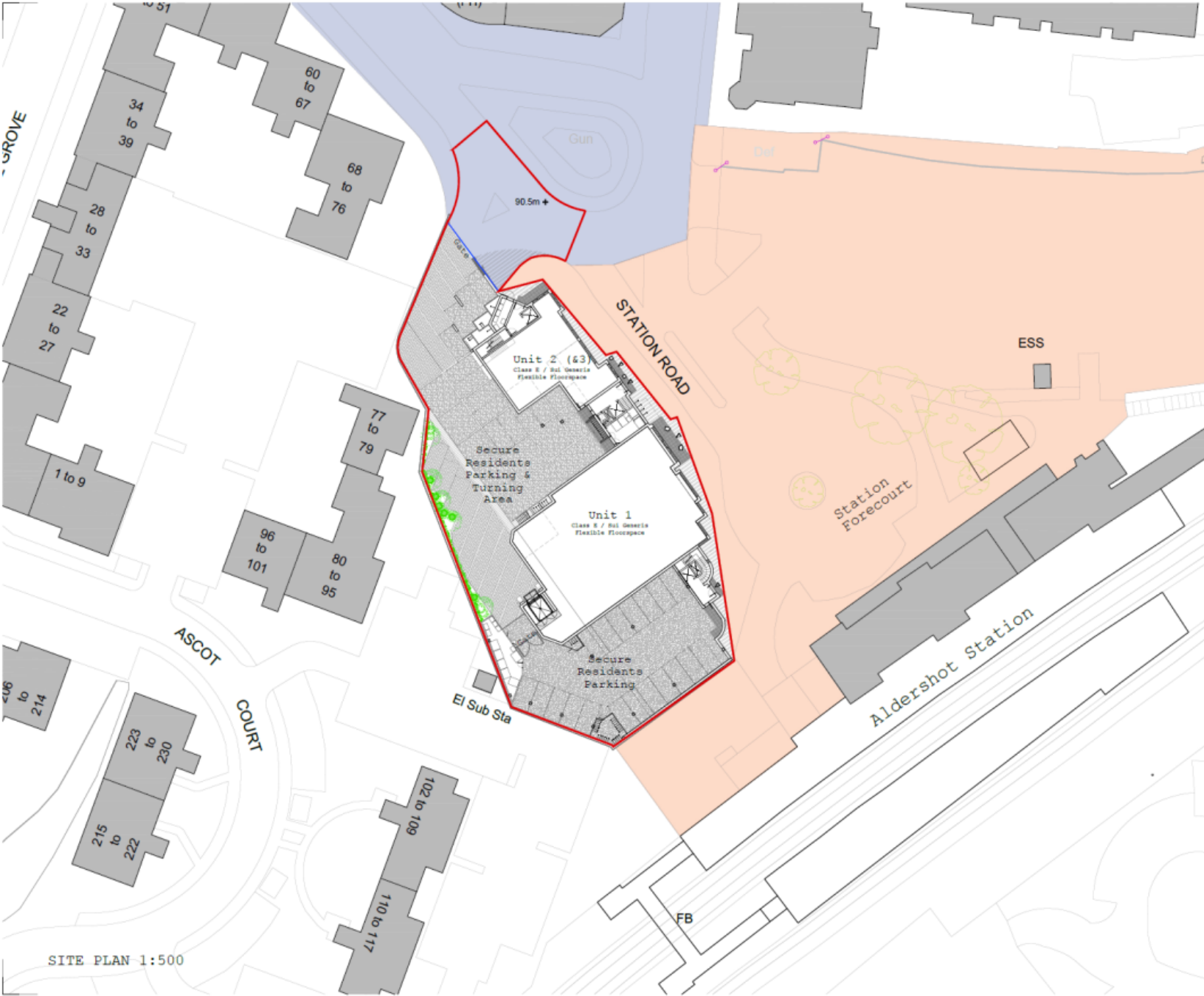



Drawing number: **128-05-21**

No Date: **By: CM** Description:

0 2 4 6 8 10m

PROPOSED ELEVATIONS 1:200



- Material Key - Indicative:**
- | | |
|---|--|
|  | Brick Pavement / Vehicle Movement & Car Parking |
|  | Brick Pavement / Vehicle Movement & Car Parking |
|  | Entrance Delineations |
|  | Balcony / Patio Delineations |
|  | Materials to tie in with the Station Forecourt upgrade (see the B&C) |
|  | Tarmac |
|  | Solar Farm |
|  | Car Parking Spaces |
|  | Proposed Planting |
|  | Grass |
|  | Green Grow Wall |
|  | Proposed Trees |

NOTES

Use National Instruments only. Write directly onto sheet or onto form to present all documents to be checked by user and any discrepancies must be accurately be reported to the relevant large scale contractors. Final the drawing off all relevant materials.

PLANNING			
Client: Mr Simon Gill			
Project: Aidershot Bus Station			
Drawings: Site Plan (Ground Floor) As Proposed			
Scale: 1:500	Date: NOV '21	Drawn By: EP	Check: CM
Working number: 128-02-10			
Rev	Date	By	Description



Development Management Committee

22/00282/FULPP

**Phase 5 : North Town Re-
development Site, Aldershot**

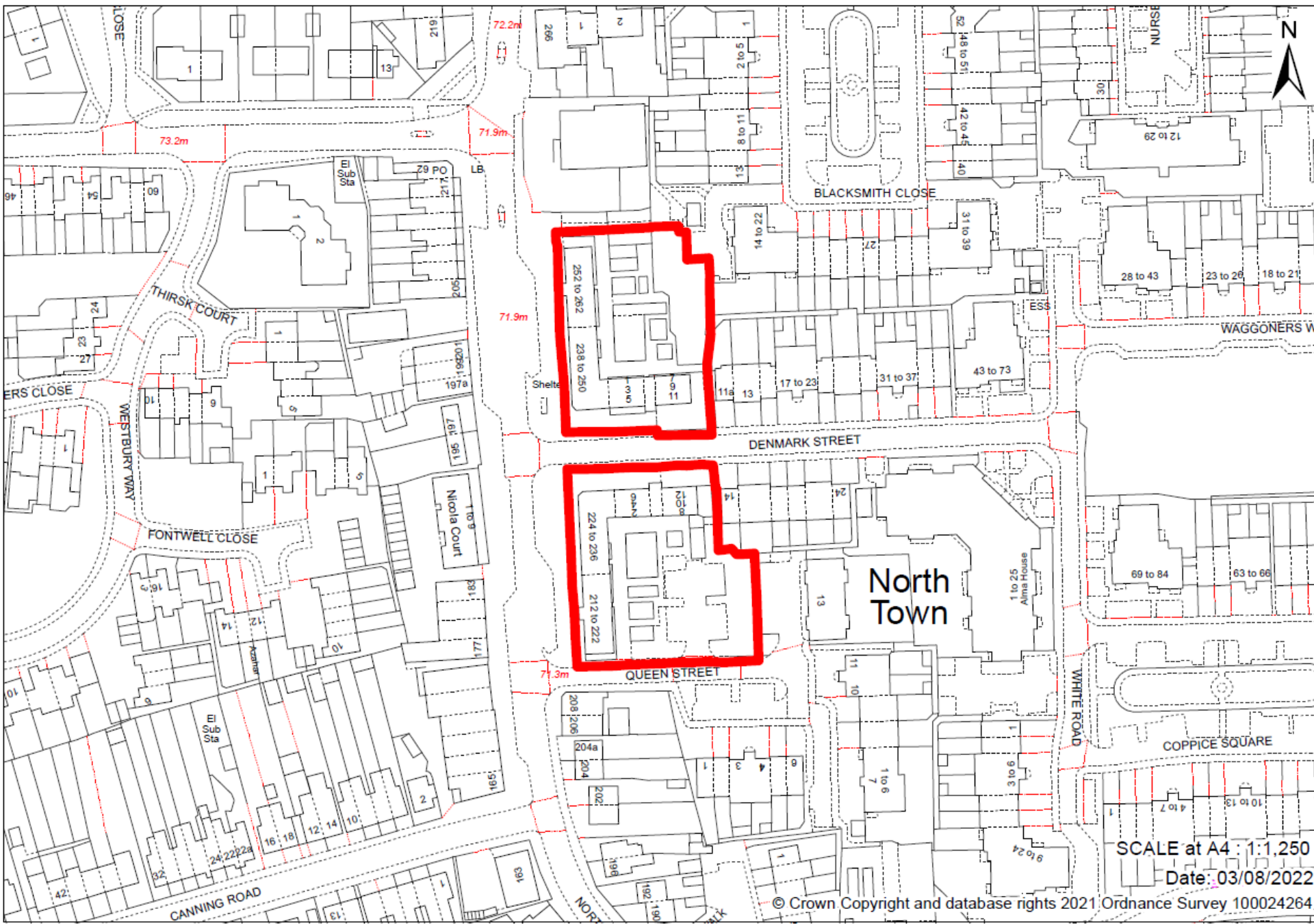

SCALE at A4 : 1:1,250

Date : 03/08/2022

© Crown Copyright and database rights 2021 Ordnance Survey 100024264







**Approved Masterplan with PP
09/00431/FULPP**



**Extract of
Approved
Masterplan with PP
09/00431/FULPP**

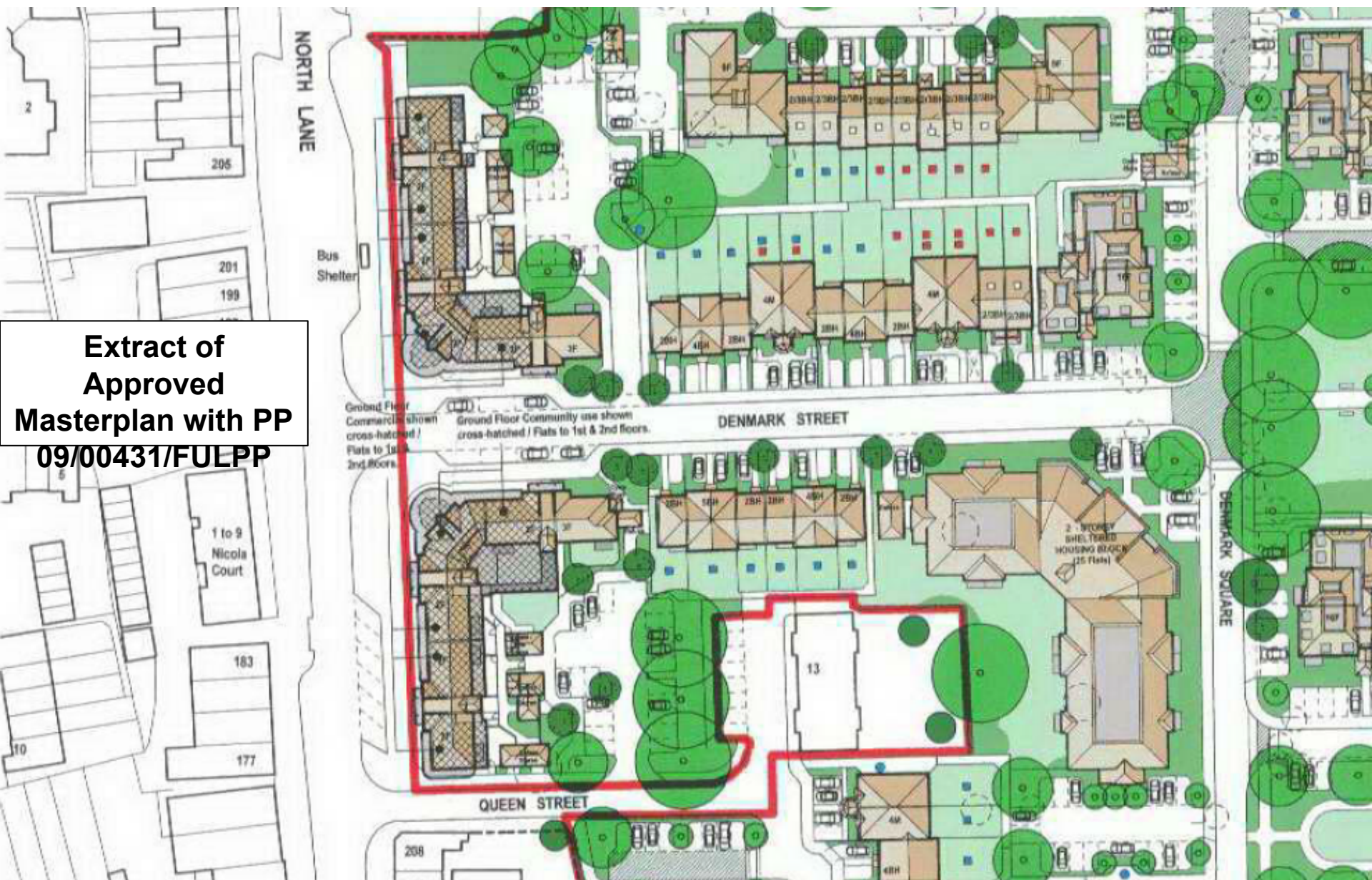

Ground Floor Plan Block 1 Approved with PP 09/00431/FULPP

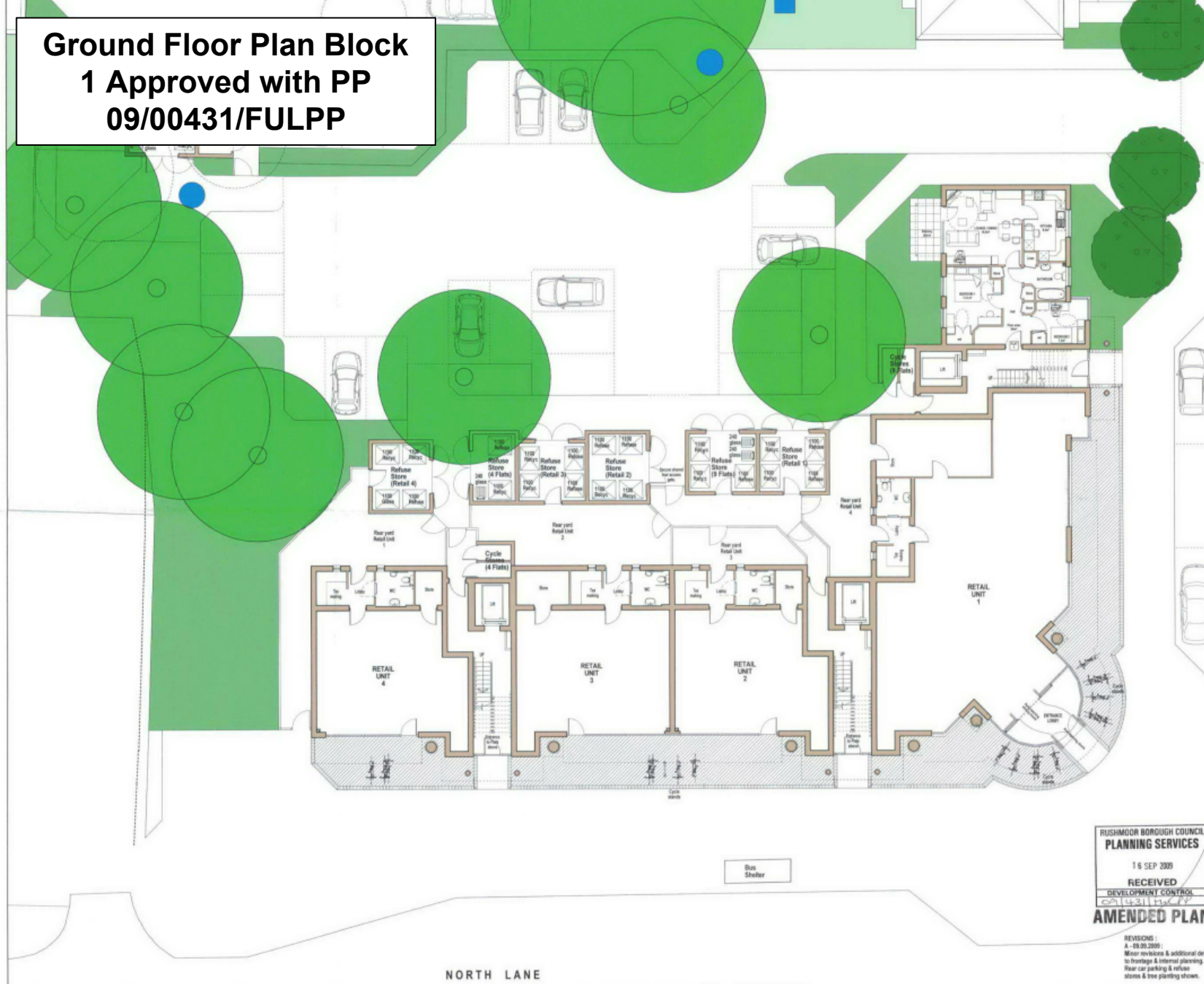

DENMARK STREET



CONCEPT HOUSE
15 KINGSTON CRESCENT, NORTH END
PORTSMOUTH, HAMPSHIRE, PO2 8AA
TELEPHONE 023 9247 3810
FACSIMILE 023 9247 3810

RUSHMOOR BOROUGH COUNCIL
PLANNING SERVICES

16 SEP 2009
RECEIVED
DEVELOPMENT CONTROL

AMENDED PLAN

REVISIONS:
A - 09.09.2009:
Minor revisions & additional detail
to frontage & internal planning.
Rear car parking & refuse
stores & tree planting shown.

PROJECT
Proposed Redevelopment:
North Town
Aldershot, Hants

DRAWING TITLE
Proposed Retail Block 1 (Units 1-4)
Ground Floor Plan

Date: July 2009

Scale: 1:100 @ A1

Drawn by: PJ

Checked by:

Drawn by:

Scale: 1:100 @ A1

Sheet: 540-PD-251

NORTH LANE

ARCHITECTURE PLANNING DESIGN PROJECT MANAGEMENT

RUSHMOOR
BOROUGH COUNCIL

Ground Floor Plan Block 2 Approved with PP 09/00431/FULPP

DENMARK STREET

QUEEN STREET

GROUND FLOOR PLAN

NORTH LANE

ARCHITECTURE PLANNING DESIGN PROJECT MANAGEMENT

RUSHMOOR
BOROUGH COUNCIL



RUSHMOOR BOROUGH COUNCIL
PLANNING SERVICES
16 SEP 2009
RECEIVED
DEVELOPMENT CONTROL

AMENDED PLAN



CONCEPT HOUSE
35 KINGSTON CRESCENT, NORTH END
PORTSMOUTH, HAMPSHIRE PO2 8AA
TELEPHONE: 023 9257 3818
FACSIMILE: 023 9257 3805

Revisions:

A - 03.08.2009
External parking area revised.
Refuse & Cycle Stores and
external works amended.
Community Centre enlarged &
detailed layout shown.
Internal layout of Retail units
shown.

PROJECT
Proposed Redevelopment:
North Town
Aldershot, Hants

DRAWING TITLE
Proposed Community Centre (The Base)
& Retail Block 2 (Units 5 - 7)
Ground Floor Plan

Date: July 2009
Drawing No: 945-PD-204
Scale: 1:100 @ A1
Rev: A



Approved Block 1 North Lane Elevation



Approved Block 2 North Lane Elevation



GENERAL NOTES:
 1. This drawing is the copyright of KSA Architects Ltd and may not be copied, altered or reproduced in any form or passed on to a third party without written consent. It is drawn A3.
 2. This drawing has been produced as a guide, and is subject to further detailed information being provided, including but not limited to a full topographical survey, service enquiries and an infrastructure study.



SITE A GROUND FLOOR PLAN
 scale 1:100



SITE A FIRST FLOOR PLAN
 scale 1:100



D	26.03.21	Planning Issue	LD	DRK
C	02.07.21	Indicative layout shown to Community Pnl.	LD	DRK
B	07.04.21	Minor amendments	LD	DRK
A	18.09.21	Final Issue	DRK	LD
Rev	Date	Description	Rev By	Chk By

KSA The people orientated placemakers.

Client **VIVID**

Project
 North Town Phase 5
 North Lane
 Aldershot

Drawing Title
**SITE A
 GROUND & FIRST FLOOR PLANS**

Drawing Status PLANNING	Scale 1:100 @ A1
Document Ref. 1233 PD201	Revision D
Drawn By DRK	

RIBA 英國
 KSA Architects Ltd, Glasgow House
 21 Langston Crescent, North End
 Portsmouth, Hampshire, PO2 6AH
 Phone: 023 9287 8628
 Email: info@ksa.co.uk
 Web: www.ksa.co.uk

GENERAL NOTES:
 1. This drawing is the copyright of KSA Architects Ltd and may not be copied, altered or reproduced in any form or passed on to a third party without written consent. If in doubt ASK.
 2. This drawing has been prepared as a guide, and is subject to further detailed information being provided, including but not limited to a full topographical survey, service enquiries and an arboriculture study.

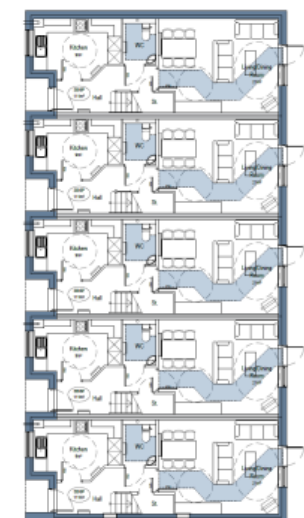

SITE B GROUND FLOOR PLAN
 scale 1:100



SITE B FIRST FLOOR PLAN
 scale 1:100

0 1 2 5 10
 (SCALE 1:100)

C	26.11.21	Planning Issue	LD	DRK
B	07.04.21	Minor amendments	LD	DRK
A	18.03.21	Final Issue	DRK	LD
Rev	Date	Description	Rev By	Clk By



Client

VIVID

Project
 North Town Phase 5
 North Lane
 Aldershot

Drawing Title	SITE B	Scale	1:100 @ A1
Drawing Status	PLANNING	Revision	C
Document Ref.	1233 PD203	Drawn By	DRK
RIBA	KSA Architects Ltd, Concept House 25 Kingston Crescent, North End Portsmouth, Hampshire, PO1 8BA	Phone: 023 927 1639 Email: info@ksaarch.co.uk Web: www.ksaarch.co.uk	

GENERAL NOTES:
 1. This drawing is the copyright of KSA Architects Ltd and may not be copied, altered or reproduced in any form or passed on to a third party without written consent, if in doubt ask.
 2. This drawing has been produced as a guide, and is subject to further detailed information being provided, including but not limited to a full topographical survey, service enquiries and an arboriculture study.



SITE A - WEST ELEVATION (Plots 17-30)
 North Lane



SITE A - SOUTH ELEVATION (Plots 17-24)
 Denmark Street

SITE A - PRINCIPLE ELEVATIONS scale 1:100

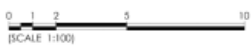

R	26.11.23	Planning Issue	LD	DRK
A	31.04.25	First Issue	LD	DRK
Rev	Date	Description	Rev By	Chk By



Client **VIVID**

Project
North Town Phase 5
North Lane
Aldershot

Drawing Title SITE A PRINCIPLE ELEVATIONS		Scale 1:100 @ A1
Drawing Status PLANNING		Drawn By LD
Drawing Ref 1233 PD302		Revision B
RIBA #		KSA Architects Ltd, Concept House 20 Clayton Crescent, North End Portsmouth, Hampshire, PO2 8AA Email: info@ksa.co.uk Web: www.ksa.co.uk



SITE B - WEST ELEVATION (Plots 01-16)
North Lane



SITE B - NORTH ELEVATION (Plots 06-16)
Denmark Street

SITE B - PRINCIPLE ELEVATIONS Scale 1:100

0 1 2 5 10
(SCALE: 1:100)

GENERAL NOTES:
1. This drawing is the copyright of KSA Architects Ltd and may not be copied, altered or reproduced in any form or passed on to a third party without written consent, if in doubt ASK.
2. This drawing has been produced as a guide, and is subject to further detailed information being provided, including but not limited to a full topographical survey, service enquiries and an arboriculture study.

B	26.11.21	Revised Issue	LD	DMK
A	31.05.21	First Issue	LD	DMK
Rev	Date	Description	Rev By	Chd By



The people
orientated
placemakers.

Client

VIVID

Project
North Town Phase 5
North Lane
Aldershot

Drawing Title
SITE B
PRINCIPLE ELEVATIONS

Drawing Status	Scale
PLANNING	1:100 @ A1
Document Ref:	Revision
1233 PD303	B LD

RIBA KSA Architects Ltd, Company House
281 Kingston Crescent, North End
Northampton, Northants, NN1 6AA
Phone: 033 3337 3818
Email: info@ksa.co.uk
Web: www.ksa.co.uk

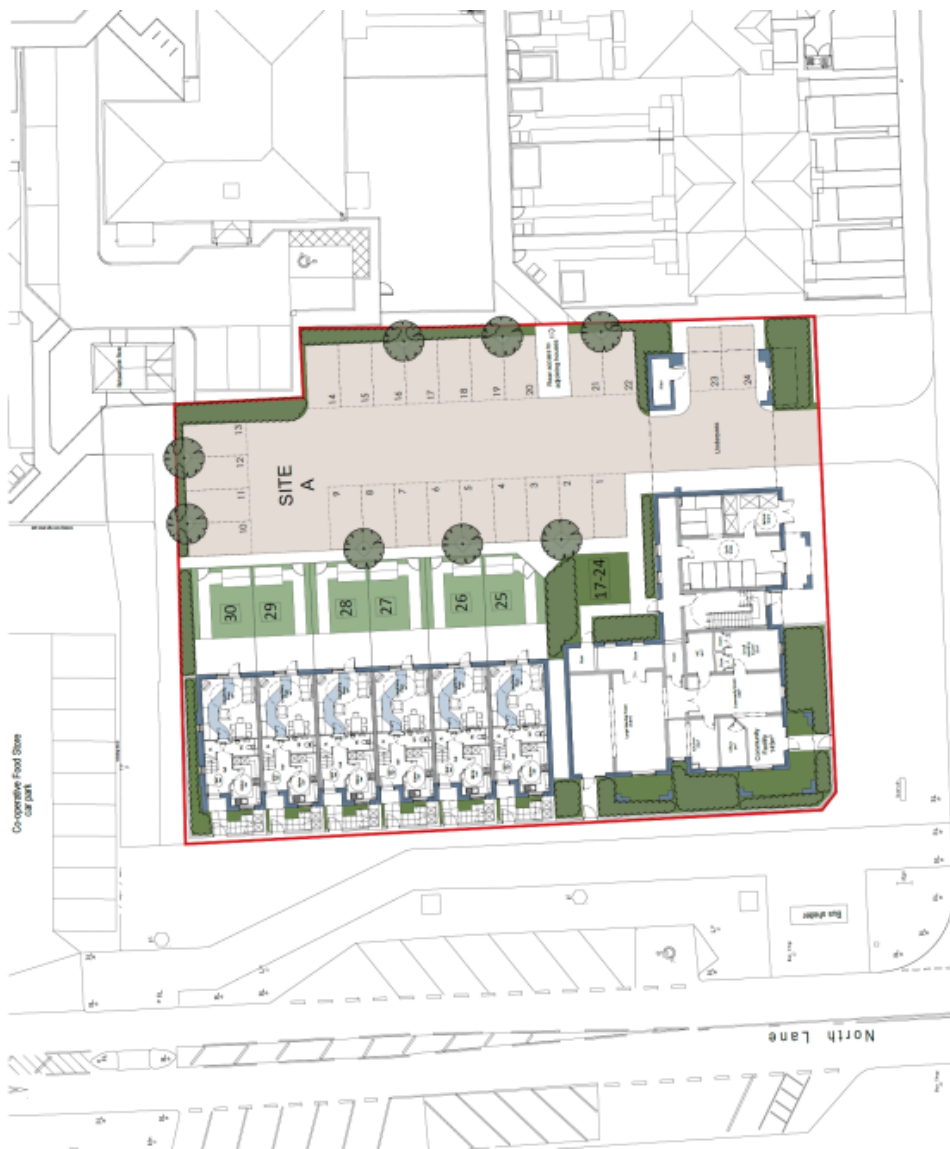

Development Management Committee

17th August 2022